

# Paraseal Membrane Waterproofing Installation Manual

## BACKFILLED WALLS

### Section A

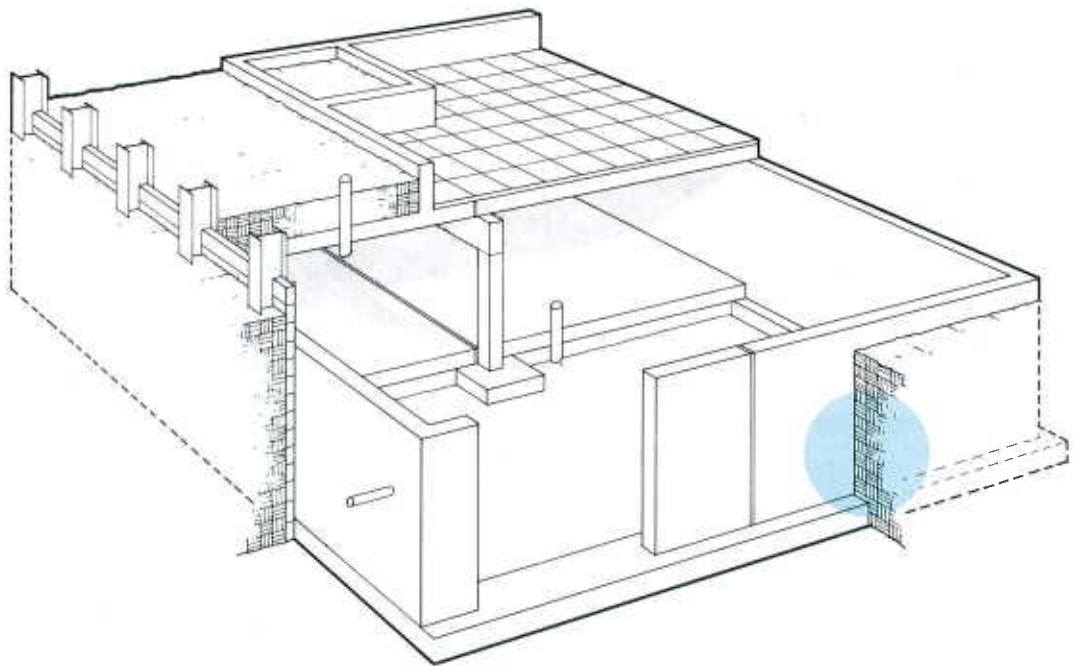

An **RPM** Company

**TREMCO INCORPORATED**  
SEALANT/WEATHERPROOFING DIVISION  
TREMCO • MAMECO/VULKEM® • PARAMOUNT

3735 Green Road, Beachwood, Ohio 44122 – Telephone: 216-292-5000 • 1-800-321-7906  
220 Wicksteed Avenue, Toronto, ON M4H 1G7 – Telephone: 416-421-3300 • 1-800-363-3213

022898/SEC.A Printed in U.S.A.

# WHAT IS PARASEAL?

Paraseal is a two component membrane manufactured by **Mameco International, Inc.** which combines the characteristics of the two most effective waterproofing materials available today; high density polyethylene (HDPE) and bentonite clay (approximately one lb./sq.

ft.). These two materials act in concert to produce a self-seaming, self-protecting waterproofing product which seals tightly to itself and any surface it comes in contact with when in the presence of water.

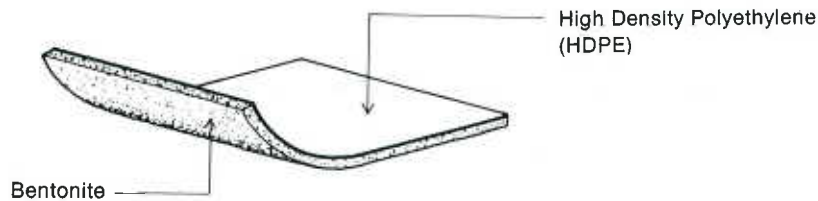

**FIGURE 1:** Paraseal Membrane.

## GENERAL INSTALLATION NOTES

### Substrate Preparation:

1. In the case of masonry walls strike flush all joints scheduled to receive Paraseal.
2. Remove all sharp protrusions as well as all dirt, mud, debris, ice, or any other materials which would interfere with Paraseal's performance. Cover any exposed reinforcing steel.
3. Trowel Vulkem 201T, Paramastic or mortar into all the holes, honeycombs, voids and irregularities which exceed  $\frac{3}{8}$ " in depth.  
**Note:** Paramastic should not be used as a full-wall trowel grade waterproofing.
4. Paraseal may be installed over uncured, damp or frozen surfaces.
5. Parge coating is not required unless the substrate is extremely rough and irregular. (Contact Paramount for recommendations on specific projects.)
6. Prepare all penetrations. (See Detail 6)
7. Prepare all expansion joints.  
**Note:** Construction cold joints require no special preparation.
8. Sweep footing ledge clean.
9. Contact MAMECO whenever conditions of acid, alkali, or salt brine exist.

### Installation:

10. Install a continuous 2" cant of Paragranular where wall meets footing. (See Figures 2 and 3).
11. Install a continuous 1" vertical cant of Vulkem 201T, or Paramastic at all vertical corners prior to installing Paraseal. (See Detail 8)

12. Paraseal is installed against backfilled walls with the granular bentonite side against the substrate and the black HDPE side facing the installer. (See Figures 2, 3 and 4)
13. Paraseal may be installed with seams running either vertically, horizontally or a combination with equal performance. (See Figure 2 and 3).  
**Note:** Shingle lap seams so that upper sheet is over lower sheet when seams are running horizontally (See Figure 3)
14. Paraseal seams in this section (except those in close clearance installations-Figure 4) shall be nailed at 24" O.C. Installations with vertically running seams (Figure 2) shall be nailed at 24"-48" O.C. and taped with Paramount Temporary Tape.
15. Terminate Paraseal with a continuous strip of Paraterm Bar nailed every 8" O.C. Tape all vertical seams with Temporary Tape. (See Detail 4 and 5)  
**Note:** Make certain that waterproofing extends up to or above finish grade.

### Backfilling:

16. Paraseal seldom requires additional protection unless the backfill contains substantial amounts of either lava rock, basalt, or any other coarse or highly abrasive materials. (Contact MAMECO for recommendations if air voids of  $\frac{3}{4}$ " or larger are trapped against walls.)
17. Even though the HDPE side of Paraseal protects it from weather and subsequent trades it is still advisable to place and compact backfill as soon as possible after installation.
18. Compact backfill to at least 85% Modified Proctor Density.

# INSTALLATION

## Seams Running Vertically

1. Prepare substrate per notes 1 thru 11 under General Installation Notes on page 2.
2. Install a continuous 2" cant of Paragranular where wall meets footing and at all other vertical to horizontal transitions.
3. Install a continuous vertical 1" cant of Vulkem 201T or Paramastic at all vertical inside corners. (See Detail 8)
4. Install Paraseal with bentonite side against substrate and nailed with washers at 24"-48" O.C.
5. Tape all vertical seams with Temporary Tape as shown.
6. Install Paraterm Termination Bar and nail every 8" O.C. Finish grade should occur either at or below Paraseal waterproofing. (See Detail 4 and 5)
7. Complete installation at penetrations as required. (See Detail 6)
8. Backfill per notes 16 thru 18 under General Installation Notes on page 2.

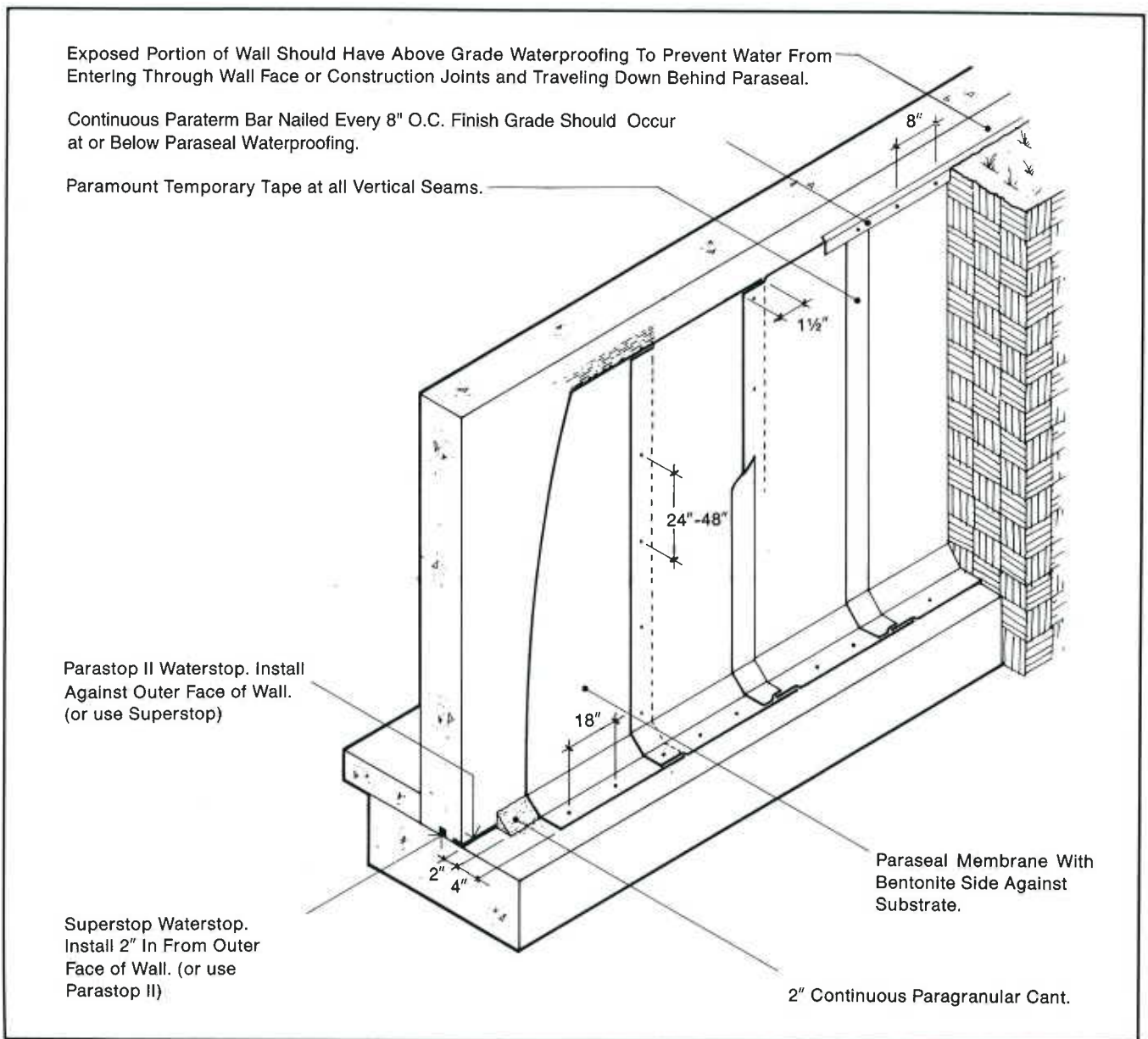
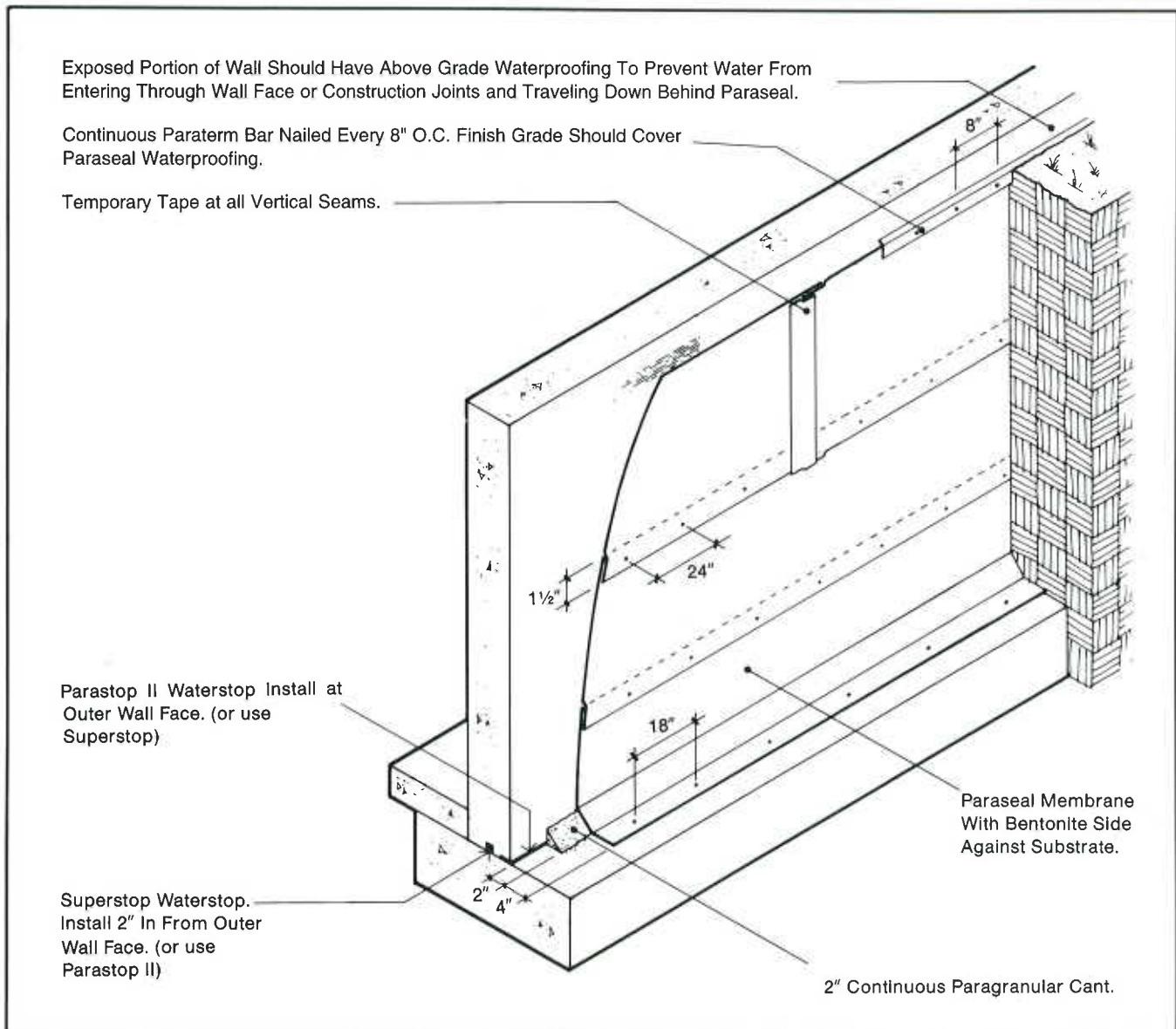

**FIGURE 2:** Paraseal Installation.

# INSTALLATION

## Seams Running Horizontally

1. Prepare substrate per notes 1 through 11 under General Installation Notes on Page 2.
2. Install a continuous 2" cant of Paragranular where wall meets footing and at all other vertical to horizontal transitions.
3. Install a continuous vertical 1" can of Vulkem 201T or Paramastic at all vertical corners. (See Detail 8)
4. Install Paraseal with bentonite side against substrate.
5. Paraseal seams shall be at least 1 1/2" and nailed with washers every 24" O.C., on horizontal and 24"-48" O.C. on vertical seams as shown.
6. Tape all vertical seams with Temporary Tape as shown.
7. Install Paraterm Termination Bar and nail every 8" O.C. Finish grade should occur either at or below Paraseal waterproofing. (Also see Details 4 and 5)
8. Complete installation at penetrations as required. (See Detail 6)
9. Backfill per notes 16 and 18 under General Installation Notes on page 2.



**FIGURE 3:** Paraseal Installation.



# TIE-IN DETAILS

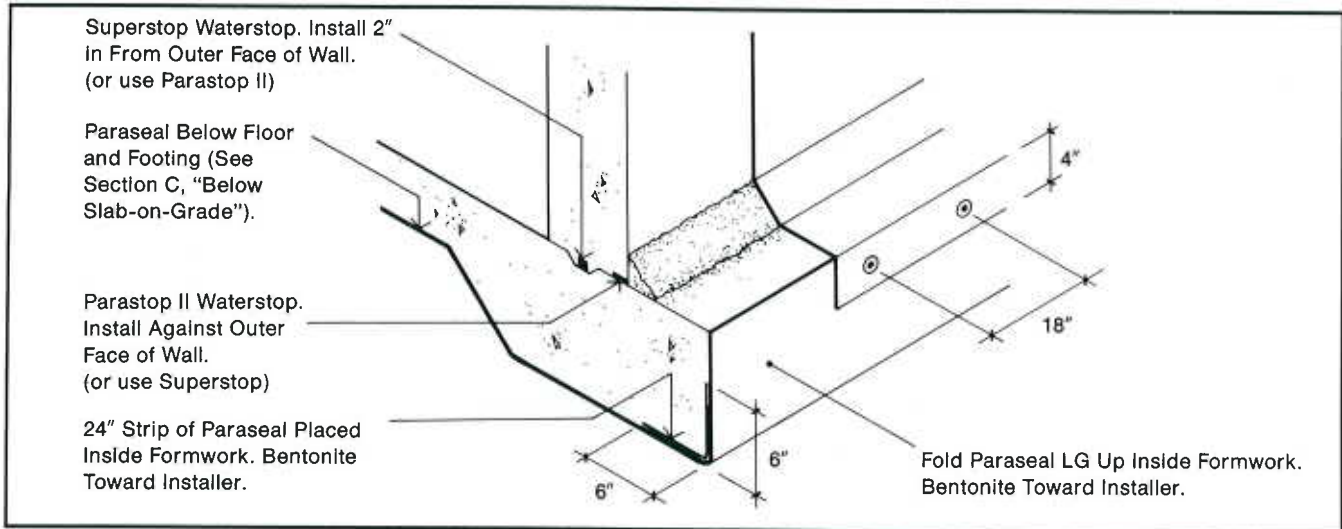

**DETAIL 1:** Tie-In Between Below Floor Paraseal and Wall Paraseal.

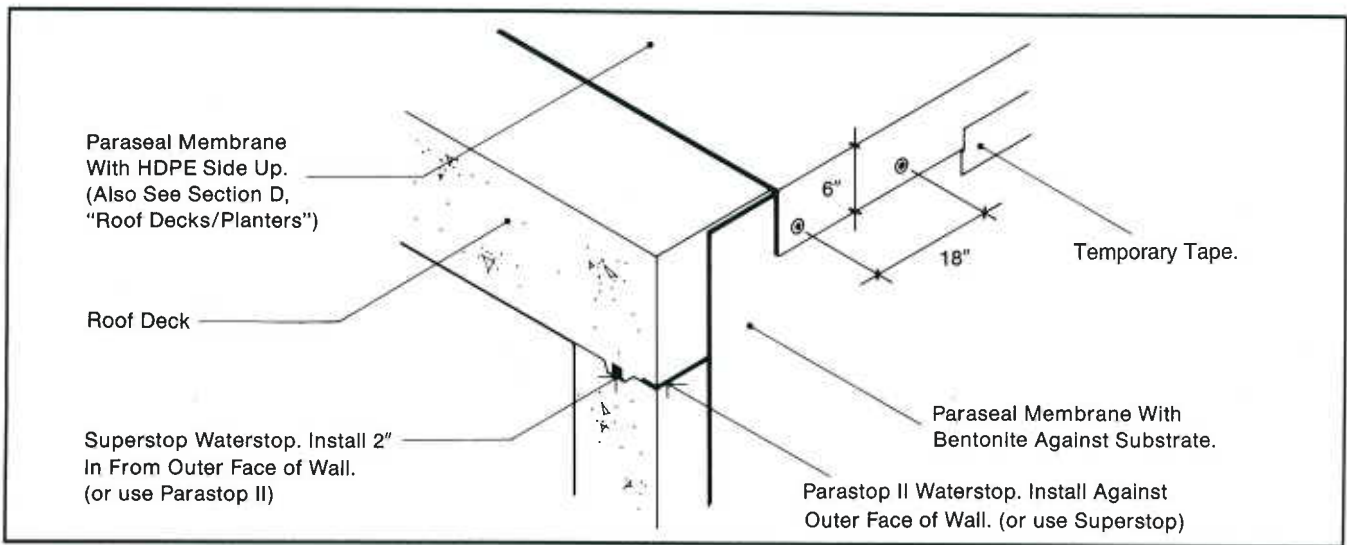

**DETAIL 2:** Tie-In Between Wall Paraseal and Horizontal Deck Paraseal.

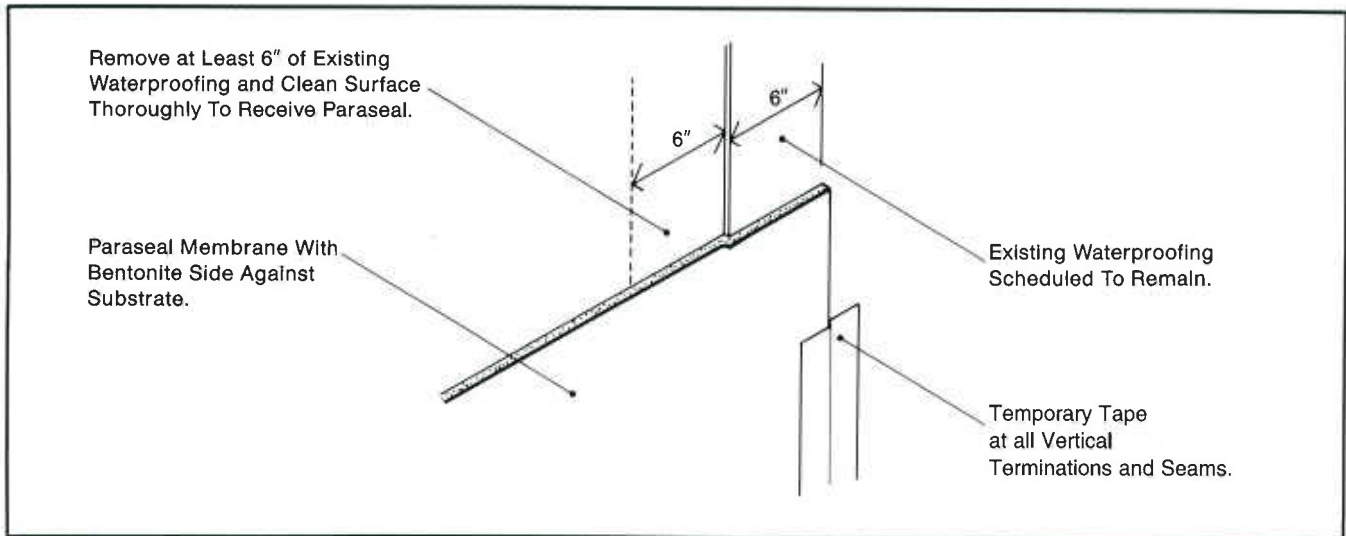

**DETAIL 3:** Tie-In of Paraseal to Other Existing Waterproofing.

# TYPICAL DETAILS

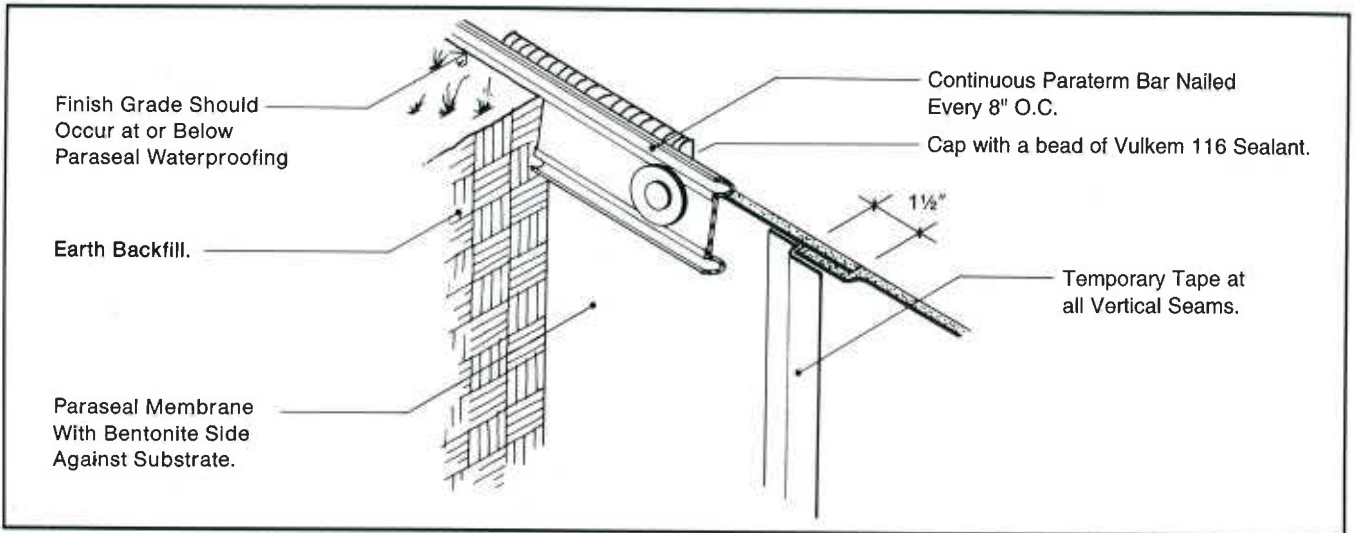

**DETAIL 4:** Typical Grade Line Termination

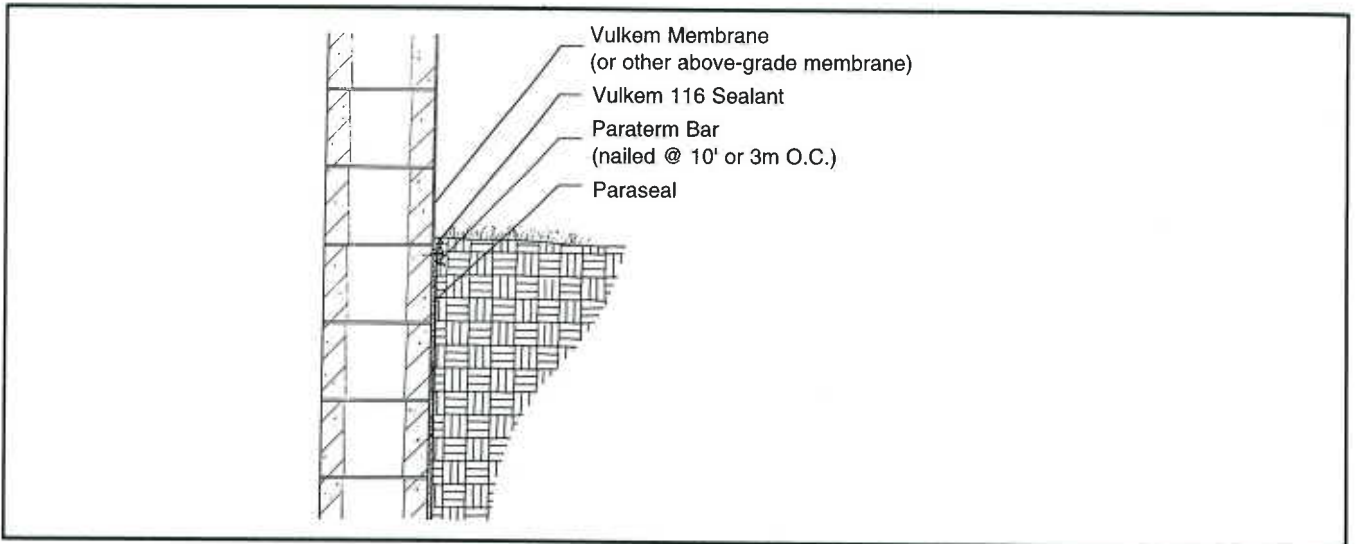

**DETAIL 5:** Typical Grade Line Termination

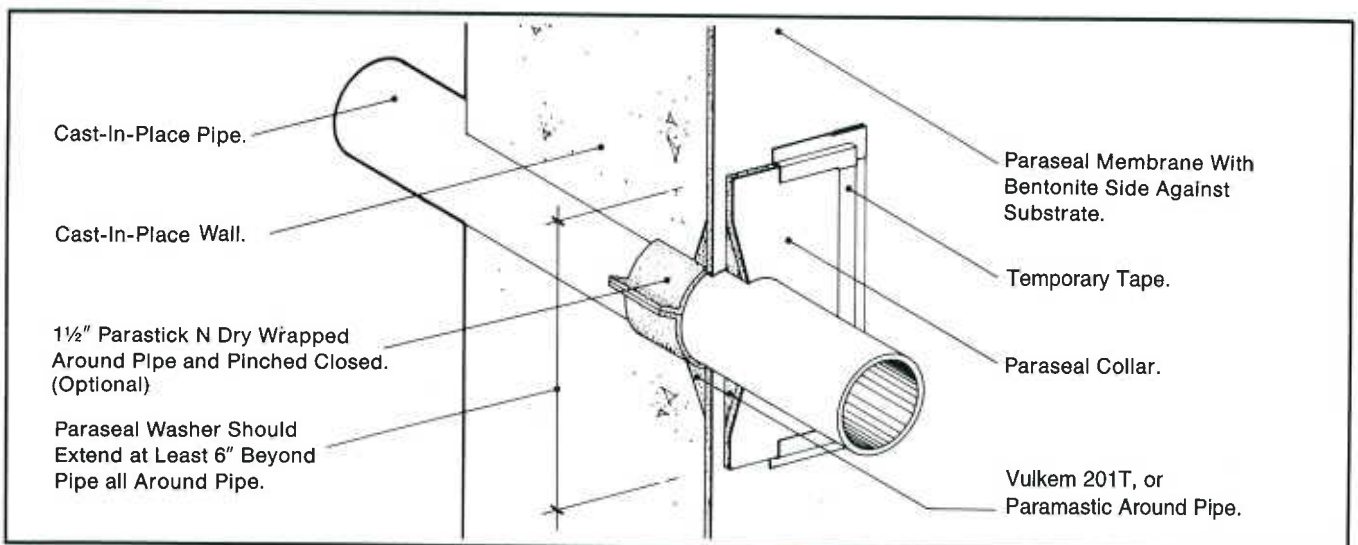

**DETAIL 6:** Typical Pipe Penetration Detail

# TYPICAL DETAILS

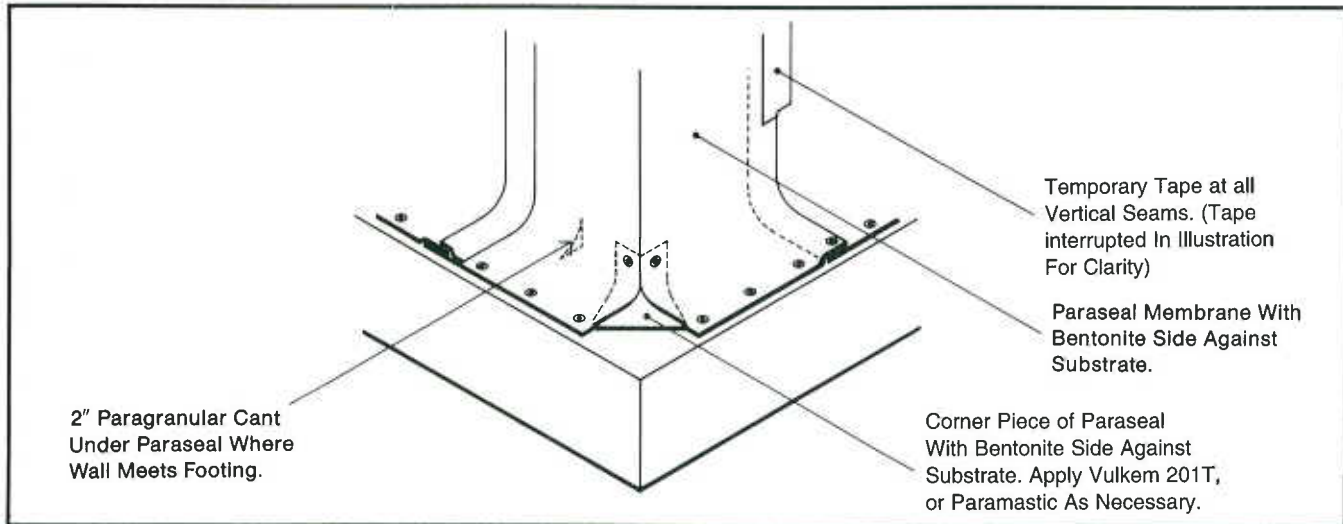

**DETAIL 7:** Typical Outside Corner.

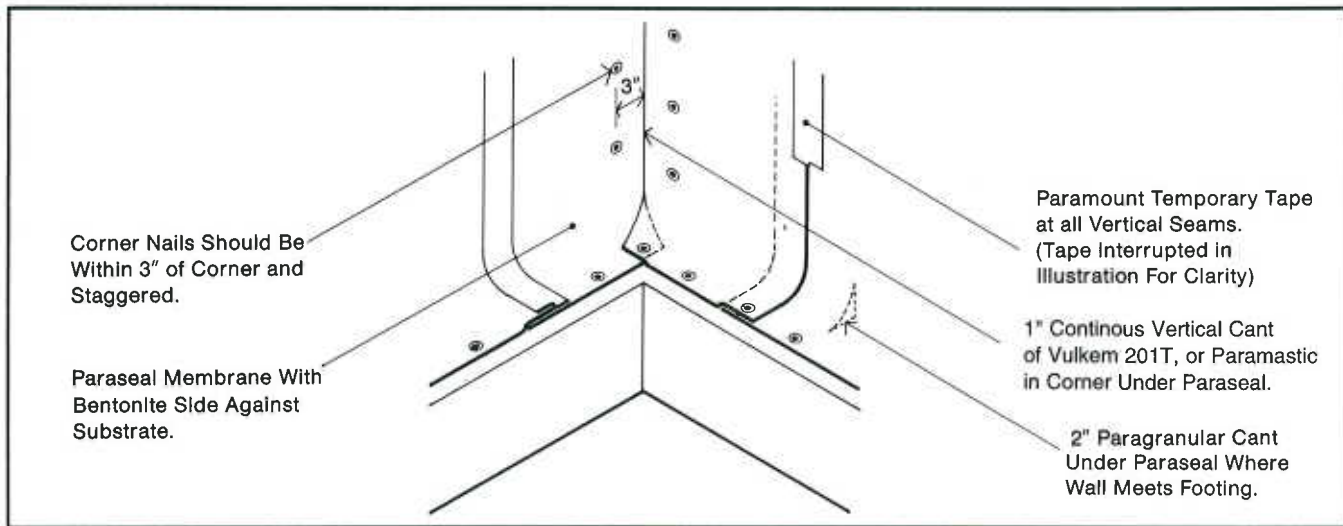

**DETAIL 8:** Typical Inside Corner.

This brochure is provided solely as an aid in determining correct preparation, installation requirements, and installation procedures. The brochure is not intended to establish product recommendations for any given installation. To the best of our knowledge the information contained herein is true and accurate at the time of issuance, but is subject to change without prior notice. Contact Mameco International to verify correctness of any applications not addressed herein.